

Modular Cooking Range Line
thermaline 80 - 1200 mm Ref-freezer
Base with 2 drawers, 1 Side, H=550
(R290)

ITEM # _____
 MODEL # _____
 NAME # _____
 SIS # _____
 AIA # _____



588484 (MA6IDAKOBO)

Ref-Freezer Base with 2
 drawers, one-side operated
 - R290

Short Form Specification

Item No.

Refrigerated base with 2 drawers, able to operate both as refrigerator or freezer, with temperature range from -22°C to +8°C. Constructed according to 1.4301 (AISI 304) with anti-tilt runners accepting GN 2/1 containers. CFC and HCFC free, highly ecological refrigerant type: R290 (ecological gas in foam: cyclopentane). Hydrocarbon refrigerant gas R290 for the lowest environmental impact (GWP=3), to reduce green house and ozone depletion effects. Flat surface construction, easily cleanable. Large digital white-digit soft touch display. Handles ergonomically designed with embedded hygienic silicon "soft" grip enable easier handling and cleaning. Connectivity ready.

IPX3 water resistance certification.

Configuration: One-side operated freestanding base.

Main Features

- Two Drawer Refrigerated/Freezer Base with built-in compressor unit.
- Unit able to operate both as refrigerator or as freezer, with temperature range from -22°C to +8°C.
- Suitable for use in ambient temperatures of up to 40 °C.
- Designed for modular installation into the cooking block.
- All major components may be easily accessed from the front.
- Each drawer to accommodate one GN 2/1 container max 150 mm high.
- Magnetic snap-in drawer gaskets are removable for cleaning.
- Forced air circulation for rapid cooling and an even temperature distribution.
- Unit may be installed on castors.
- Connectivity ready for real time access to connected appliances from remote and data monitoring (requires optional accessory).
- Unit constructed according to DIN 18860_2 with 70 mm recessed plinth.
- Perforated top surface and bottom plate for a better air circulation.
- Handles are ergonomically designed with silicon "soft" grip for easy handling and cleaning.

Construction

- Large digital white-digit display with soft touch buttons.
- Constructed in Stainless steel with Scotch Brite finish to meet the highest hygiene standards.
- Built-in compressor to suit operating conditions.
- IPX3 protected.

Sustainability



- CFC and HCFC free, highly ecological refrigerant type: R290 (ecological gas in foam: cyclopentane). Hydrocarbon refrigerant gas R290 for the lowest environmental impact (GWP=3), to reduce green house and ozone depletion effects.

Optional Accessories

APPROVAL: _____

Front

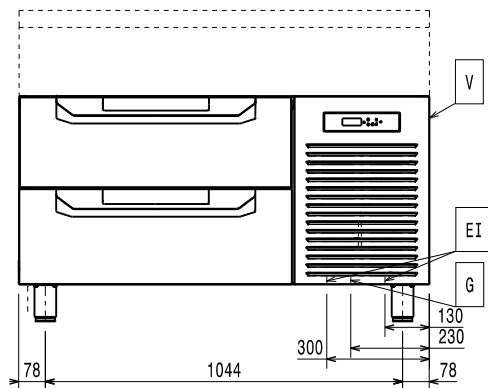

Side

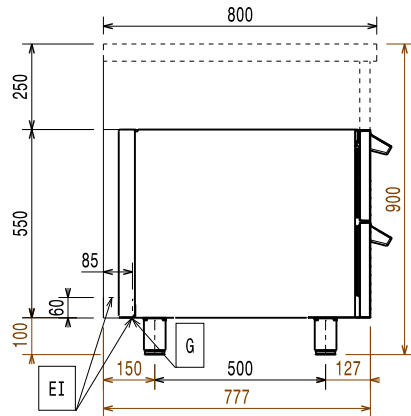

EI = Electrical inlet (power)

Top

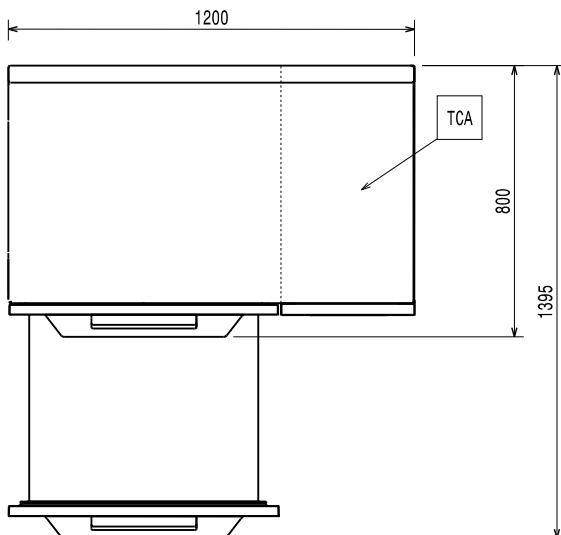

Electric

| | |
|------------------------|-----------------------|
| Supply voltage: | 220-240 V/1N ph/50 Hz |
| Electrical power, max: | 0.55 kW |
| Total Watts: | 0.55 kW |

Key Information:

| | |
|------------------------------|---------|
| External dimensions, Width: | 1200 mm |
| External dimensions, Depth: | 800 mm |
| External dimensions, Height: | 550 mm |
| Net weight: | 145 kg |
| N° of drawers: | 2 |
| Gross capacity: | |

Refrigeration Data

| | |
|-----------------------------|----------|
| Operating temperature min.: | 8 °C |
| Operating temperature max.: | -22 °C |
| Compressor power: | |
| Defrost type: | Electric |

Sustainability

| | |
|----------------------|----------|
| Current consumption: | 4.2 Amps |
| Refrigerant type: | R290 |
| Refrigeration power: | 0 W |
| Refrigerant weight: | 120 g |